

ADDITIONAL PLAN

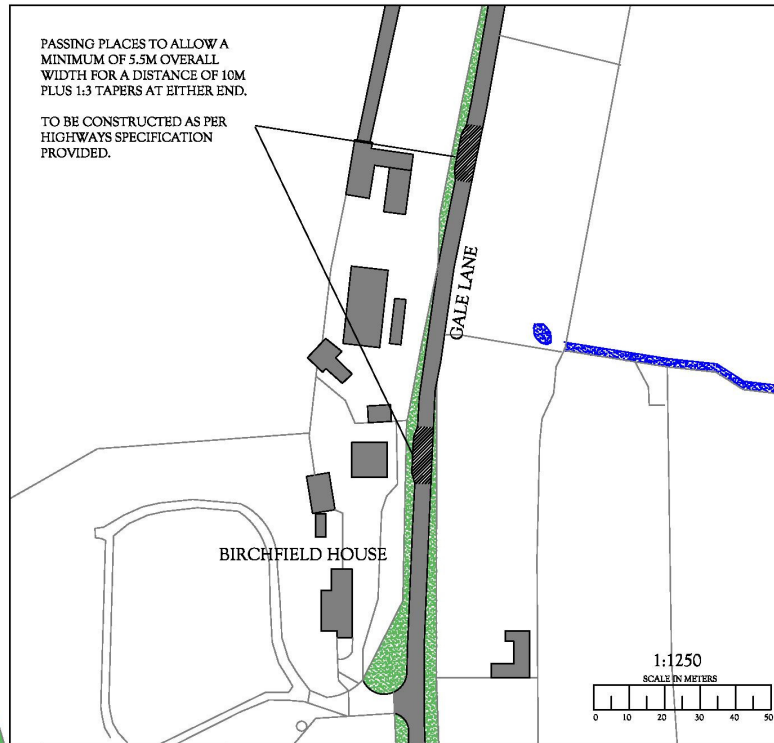

PASSING PLACES AS PROPOSED

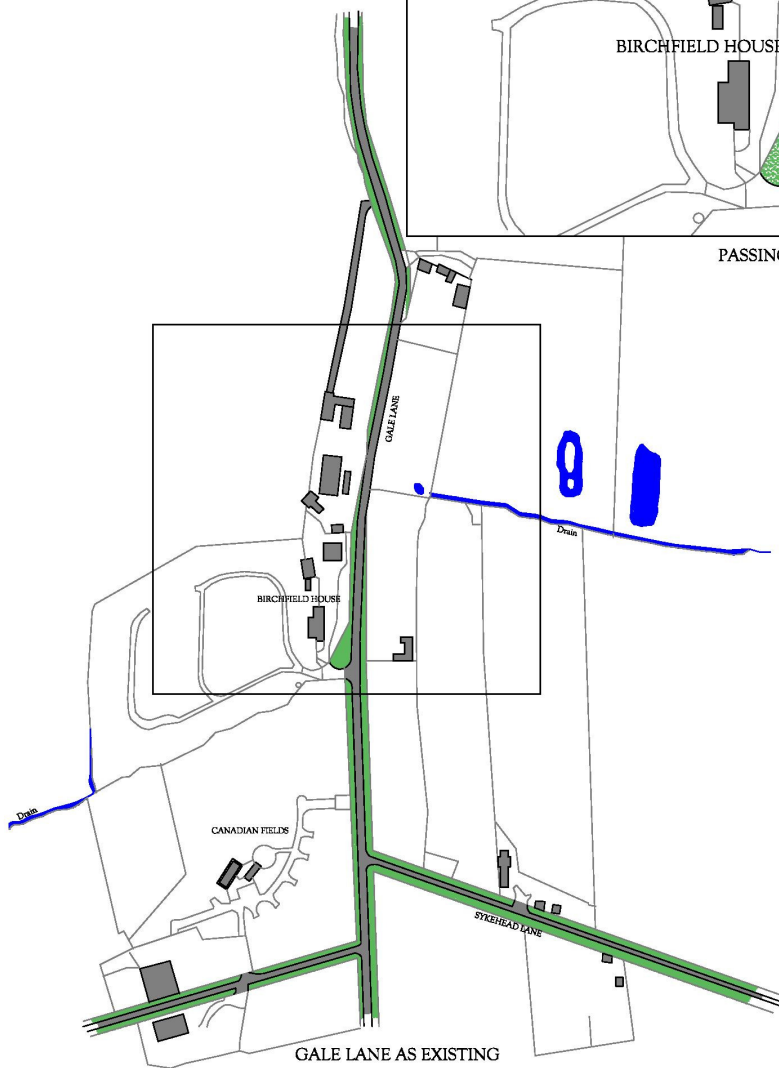

THIS COPY HAS BEEN MADE BY OR WITH THE AUTHORITY OF RYEDALE DISTRICT COUNCIL PURSUANT TO SECTION 47 OF THE COPYRIGHT DESIGNS AND PATENTS ACT 1988. UNLESS THAT ACT PROVIDES A RELEVANT EXCEPTION TO COPYRIGHT, THE COPY MUST NOT BE COPIED WITHOUT THE PRIOR PERMISSION OF THE COPYRIGHT OWNER.

<p>Felicity Kaye Drawing services Tel. 07516135303. email: felicity2kayes@aol.com</p>	
<p>CLIENT: MISS J BULMER</p>	<p>DRAWING: PROPOSED PASSING PLACES ON GALE LANE</p>
<p>PROJECT: CANADIAN FIELDS NAWTON</p>	<p>SCALE: 1:2500 @ A3</p> <p>DATE: OCT 2016</p> <p>SHEET No: 03</p> <p>DATE: 25/01/17</p> <p>All dimensions and levels to be checked on site by contractor prior to works commencing. Do not scale from drawing.</p>